

ADDENDUM NO. 1

BID AND CONTRACT DOCUMENTS

FOR

BID No. 10P2

**CHAFFEY COMMUNITY COLLEGE DISTRICT
FONTANA CENTER EXTERIOR PAINTING
FONTANA, CALIFORNIA
COUNTY OF SAN BERNARDINO**



Chaffey College

CHAFFEY COMMUNITY COLLEGE DISTRICT
5885 Haven Avenue
Rancho Cucamonga, CA 91737

The following changes, additions, deletions, clarifications, or corrections shall become part of the Bid and Contract Documents for Chaffey Community College District Bid No. 10P2, Fontana Center Exterior Painting Project at the Fontana Campus, first advertised July 28, 2009. All other terms, specifications, and conditions remain the same. Each bidder is responsible for transmitting this information to all affected subcontractors and suppliers prior to the opening of bids. Each bidder shall acknowledge receipt of this Addendum on its Bid Form.

Modifications are identified by "clouds" and the following: Deletions ~~striketrough~~
Insertions/Substitutions *italic-underlined*.

Item 1: **Modify** the existing Paragraph M of Part 7. CONTRACT APPENDIX, SUBPART B, SUPPLEMENTARY GENERAL CONDITIONS, to change the experience criteria from two years to three years, as follows:

M. This Bid requires the successful Contractor to have the following experience and technical expertise in order to be responsive:

- a. The Contractor must have been in business under the same name/license number at the same location for a period of not less than ~~two (2)~~ **three (3)** continuous years. Contractor must provide this information in Section 4, Bidder Information Forms, subsections 4A4.0 and 4A5.0.
- b. The Contractor, as a **prime or subcontractor** under its current license number, must have completed:
 - (1) at least **three (3)** exterior painting projects for a California public school district, community college, university, or other public entity
 - a. with a construction cost of \$25,000 or more,
Contractor **must** use **different** projects to satisfy each requirement(s) above. Contractor must provide this information in Section 4, Bidder Information Forms, subsection 4C.
- c. Contractor shall have provided accurate and complete information in Section 4, Bidder Information Forms, which is verifiable.

Item 2: **Delete** the existing Part 7. CONTRACT APPENDIX, SUBPART M, SPECIFICATIONS TABLE OF CONTENTS and **replace** with the revised Part 7. CONTRACT APPENDIX, SUBPART M, SPECIFICATIONS TABLE OF CONTENTS, attached to this Addendum.

Item 3: **Delete** the existing Paragraph 2.01.B of SPECIFICATIONS SECTION 09 01 90, REPAIRING AND PAINTING OF EXISTING PAINTED SURFACES, and **replace** with the following:

B. Or equal as approved in accordance with the General Conditions and Supplementary General Conditions.

Item 4: **Delete** the existing Paragraph 1.02 of SPECIFICATIONS SECTION 09 06 00, SCHEDULES FOR FINISHES, and **replace** with the following:

1.02 PRODUCT OPTIONS

A. Product submittals and substitutions shall be processed in accordance with the General Conditions and Supplementary General Conditions.

Item 5: **Delete** the existing Paragraph 2.01.A.6 of SPECIFICATIONS SECTION 09 90 00, PAINTING, and **replace** with the following:

6. Or equal as approved in accordance with the General Conditions and Supplementary General Conditions.

Item 6: **Add** the attached Sheet No. AD-1.1 entitled "Trash/Equipment Enclosure Elevations" (8/12/09) to the end of the Instructions to Bidders.

A. Contractor shall include Sheet No7. AD-1.1 within their bid.

END OF ADDENDUM NO. 1

CHAFFEY COMMUNITY COLLEGE DISTRICT
FONTANA CAMPUS
BID NUMBER 10P2
FONTANA CENTER ~~PHASE I~~ EXTERIOR PAINTING

SPECIFICATIONS TABLE OF CONTENTS

DIVISION 1 – GENERAL REQUIREMENTS

SECTION

01010	SUMMARY OF WORK
01020	<u>PROJECT</u> PHASING & MILESTONE
01500	CONSTRUCTION FACILITIES, USE OF PREMISES & TEMPORARY CONTROLS
01600	MATERIAL AND EQUIPMENT
01630	PRODUCT SUBMISSION
01740	FINAL CLEANING
09019	<u>09 01 90</u> REPAIRING & PAINTING OF EXISTING PAINTED SURFACES
09060	<u>09 06 00</u> SCHEDULE FOR FINISHES
09900	<u>09 90 00</u> PAINTING

△	ADDENDUM NO. 1	DSA FILE NO. N/A
		APPLICATION NO. N/A

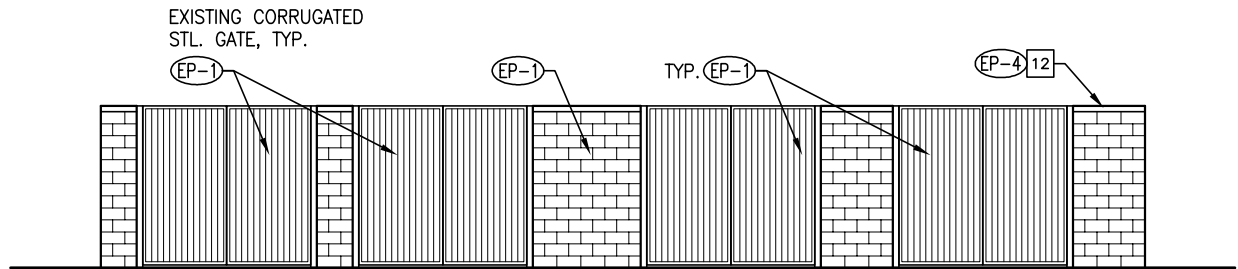

WEST ELEVATION

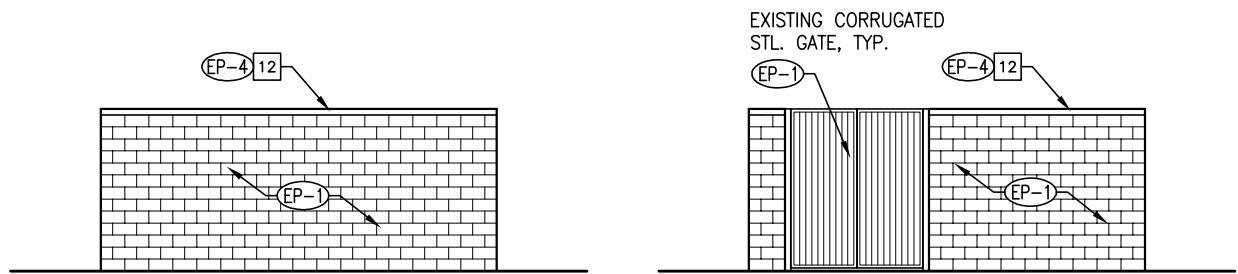

SOUTH ELEVATION

NORTH ELEVATION

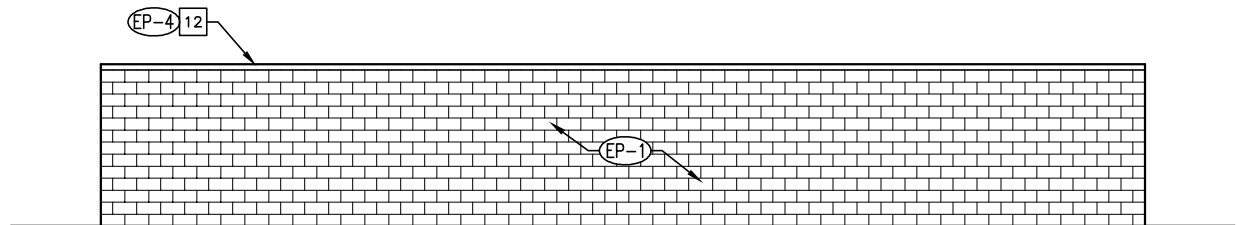

EAST ELEVATION

NOTE:
Paint all interior and exterior surfaces of masonry enclosure and gates. Refer to Sheet A2.1 for keynote legend.

N:\Projects\3017 Chaffey College\044_Fortana Ph 1 Painting\18-CAD\044_Fortana Ph 1 Painting\Addendum\AD-1.1.dwg 8/13/2009 9:44 AM Brett Leovitt

	Drawing Title: Trash/Equipment Enclosure Elevations	
	Reference Drawing: A2.1 A2.2	
<p>3546 Concourse Street Ontario, California 91764 Phone 909-989-9979 • Fax 909-483-1400 www.hmcarchitects.com</p>	<p>CHAFFEY COLLEGE FONTANA CENTER EXTERIOR PAINTING</p> <p>16855 Merrill Avenue Fontana, CA 92335</p>	Project No. 3017044
		Scale: 3/32"=1'-0"
		Date: 8/12/09
		AD-1.1